

TOTAL EXTENT : 3936 SQ.M ✓
 PASSAGE AREA : 182 SQ.M ✓
 NO.OF.PLOTS : 22 Nos. ✓

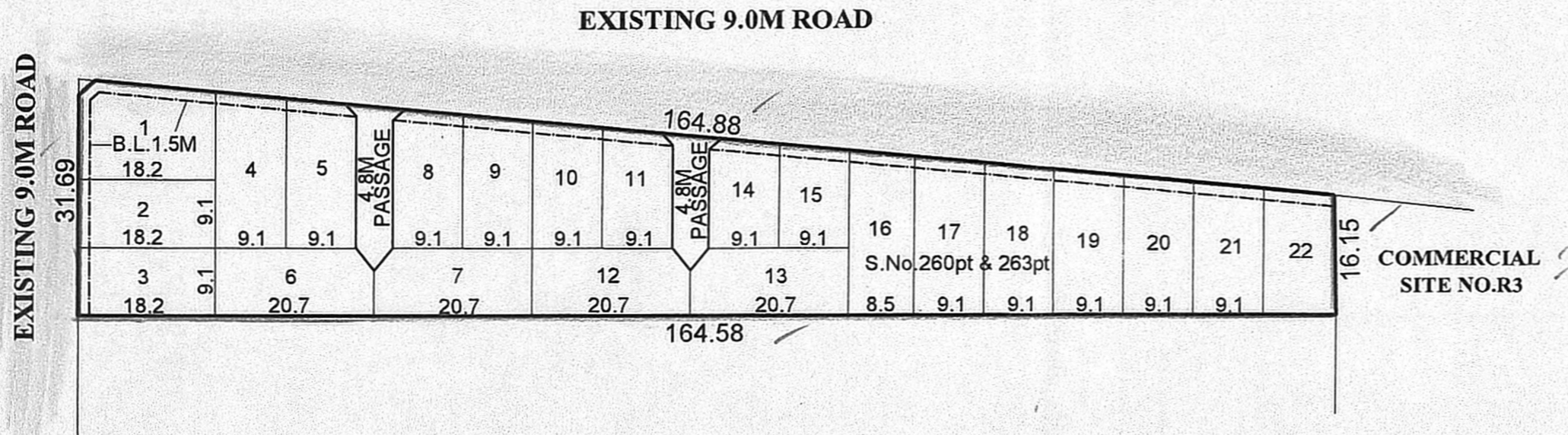



CONDITIONS:

(I) DR RULE NO: 29 (11)

THE COST OF LAYING IMPROVEMENTS TO THE SYSTEMS IN RESPECT OF ROAD, WATER SUPPLY, SEWERAGE, DRAINAGE OR ELECTRIC POWER SUPPLY THAT MAY BE REQUIRED AS ASSESSED BY THE COMPETENT AUTHORITY, SHALL BE BORNE BY THE APPLICANT.

(II) TAMILNADU HOUSING BOARD IS RESPONSIBLE FOR THE SHAPE, SIZE & DIMENSIONS OF THE SITE UNDER REFERENCE.

LEGEND :

-  SITE BOUNDARY ✓
-  EXISTING ROAD ✓

S. Sundar
 16/4/19
 PREPARED BY

[Signature]
 16/4/19
 P.A.II

[Signature]
 16/04/2019
 A.P

GREATER CHENNAI CORPORATION ✓
TAMIL NADU HOUSING BOARD ✓

PART LAYOUT OF HOUSE SITES IN THE SITE RESERVED FOR GROUP HOUSING BEARING NO. AA-390, MANALI PHASE-II SITES & SERVICES SCHEME IN S.No.260 part & 263 part OF SADAYANKUPPAM VILLAGE.

(THIS REVISES EARLIER APPROVED LAYOUT NO.6/98)

SCALE-1:800 (ALL MEASUREMENTS ARE IN METRE)

CONDITION:-
 THE LAYOUT APPROVAL IS VALID SUBJECT TO OBTAINING SANCTION FROM THE LOCAL BODY CONCERNED

P.P.D (TNHB) NO : G 02
 L.O 2019
APPROVED

VIDE LETTER NO : L2/10373/2018 ✓
 DATED : / 04 / 2019 ✓

[Signature]
 16/4/19
 FOR SENIOR PLANNER(MSB)
 CHENNAI METROPOLITAN
 DEVELOPMENT AUTHORITY

